

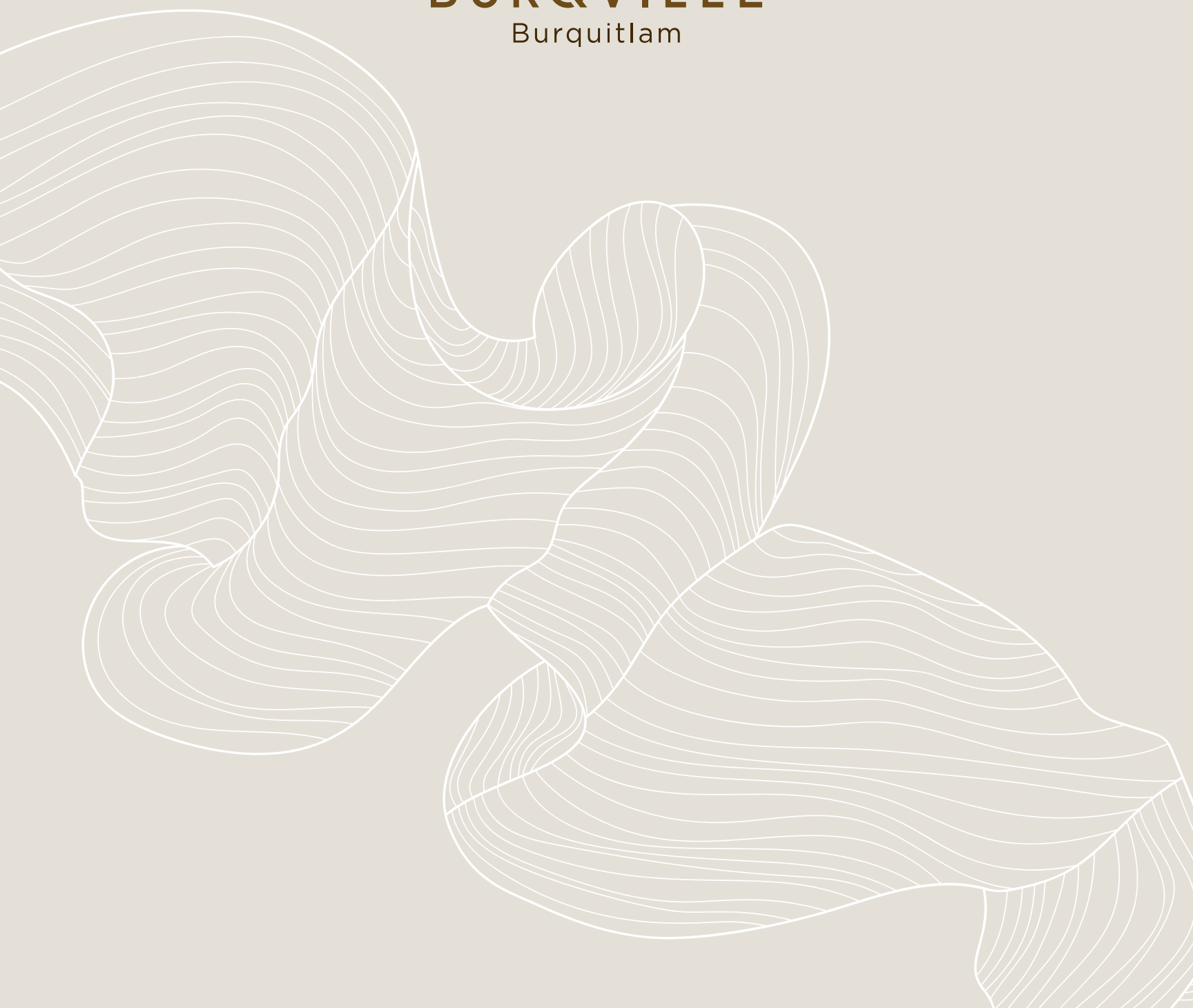

BURQVILLE

Burquitlam





INTRODUCING

BURQVILLE

*An Exclusive Collection of
50 West Coast Inspired Luxury Townhomes*

Embrace family-focused living in the expanding community of Burqville, nestled between Regan and Grover Avenue. This quiet residential enclave is just a short walk from the nearby Burquitlam SkyTrain Station and Burquitlam Plaza, where you'll find a variety of grocery stores and dining opportunities. Additionally, the brand-new YMCA offers recreational facilities for the whole family to enjoy.

Burqville's location effortlessly connects residents to major hubs across Metro Vancouver, ensuring that an urban connected lifestyle is always within reach. Just a few minutes' drive away is the bustling Lougheed Town Centre, a haven for shoppers and food lovers seeking diverse culinary experiences. With its ideal location, excellent amenities, and a strong sense of community, Burqville is not just a place to live, it's a place to call home.



BURQVILLE

Layered Living Experiences

Burqville represents a shift from single-level homes to residences tailored to evolve with you, an approach we call Layered Living. Our 3-bedroom private townhomes showcase multi-level functionality, reflecting our architectural vision and your family's journey through the home's unique layers.

These interconnected layers nurture stronger bonds between families and neighbors, promoting greater comfort and harmonious living dynamics. In this welcoming community, Burqville's Layered Living ushers in a vibrant, multifaceted lifestyle.

SURREY 25 min	NEW WESTMINSTER 15 min	K-TOWN 5 min	LOUGHEED TOWN CENTRE 5 min	BURQUITLAM STATION & PLAZA 5 min walk 🚶 🚊	BURNABY MOUNTAIN 5 min	SIMON FRASER UNIVERSITY 6 min	NORTH VANCOUVER 25 min	REED POINT MARINA 10 min	PORT MOODY 8 min
------------------	---------------------------	-----------------	-------------------------------	---	---------------------------	----------------------------------	---------------------------	-----------------------------	---------------------



Burquitlam Is Connected

Nestled at the crossroads of Burnaby and Coquitlam, the name Burquitlam is a fusion of these two cities, emphasizing the area's connectivity. Burquitlam's prime location makes it perfect for commuters and local destination seekers alike.



A Destination For Some Local For Others

As a thriving and diverse community, Burnaby is emerging as a sought-after destination for those desiring a balanced lifestyle amid modern conveniences without the chaos. Catering to various tastes, needs, and ages, this vibrant locale has something for everyone.

Culinary enthusiasts can explore Koreatown for authentic cuisine, while shopping aficionados can hop on the SkyTrain to the City of Lougheed Shopping Centre, featuring over 160 stores. Golfers can enjoy a quick 5-minute drive to the renowned Vancouver Golf Club for a morning round. Additionally, Simon Fraser University, perched atop the iconic Burnaby Mountain, is a mere 6 minutes away for those pursuing higher education.





Strategically-located

A thriving community

BURQUITLAM SKYTRAIN STATION 5 Min Walk from Burqville

SHOPPING & GROCERY
 Burquitlam Plaza
 Safeway
 Northgate Village
 Lougheed Shopping Centre
 Hannam Supermarket
 H-Mart

FOOD & BEVERAGE
 BjornBar Bakery
 Connected Minds Cafe
 Katsuya
 Sweetheony Dessert
 The Wild Fig
 The Taphouse
 Joey Coquitlam
 Kokoro Tokyo Mazesoba

PARKS & RECREATION
 Burnaby Mountain Bike Trail
 Burquitlam Park
 Lyndhurst Park
 East Grove Park
 Cameron Park
 Miller Park

EDUCATION
 Roy Stibbs Elementary
 Mountain View Elementary
 Ecole Banting Middle School
 Burnaby Mountain Secondary
 Coquitlam College

ACTIVITIES
 Goodlife Gym
 EXIT Burnaby
 YMCA
 Vancouver Golf Club
 Burnaby Public Library
 Cameron Rec. Complex
 Executive Plaza Hotel
 Zone Bowling

IKEA, CINEPLEX 5 Min Drive
SIMON FRASER UNIVERSITY 6 Min Drive
COQUITLAM CENTRE 11 Min Drive
BRENTWOOD TOWN CENTRE 15 Min Drive
METROPOLIS AT METROTOWN 23 Min Drive



The Sanctuary You Call Home

Burqville welcomes you to discover the enriching benefits of Layered Living, creating a sanctuary that offers an abundance of opportunities to enhance your lifestyle.





Meticulously Crafted In Every Detail

Stepping into a Burqville home, you'll find yourself immersed in a spacious, open-concept area that harmoniously combines warmth and modern elegance. The 9-foot ceiling height adds to the grandeur, while floor-to-ceiling windows allow sunlight to fill the entire area, heightening the luxurious ambiance.

The effortless connection between the living room and kitchen sets the stage for memorable gatherings or cozy family moments. Distinctive features, including premium flooring and a tasteful color palette, elevate the space, infusing daily living with refined sophistication.



A Kitchen
Speaks Volumes
About a Home

Fully Integrated Fulgor Milano Appliances

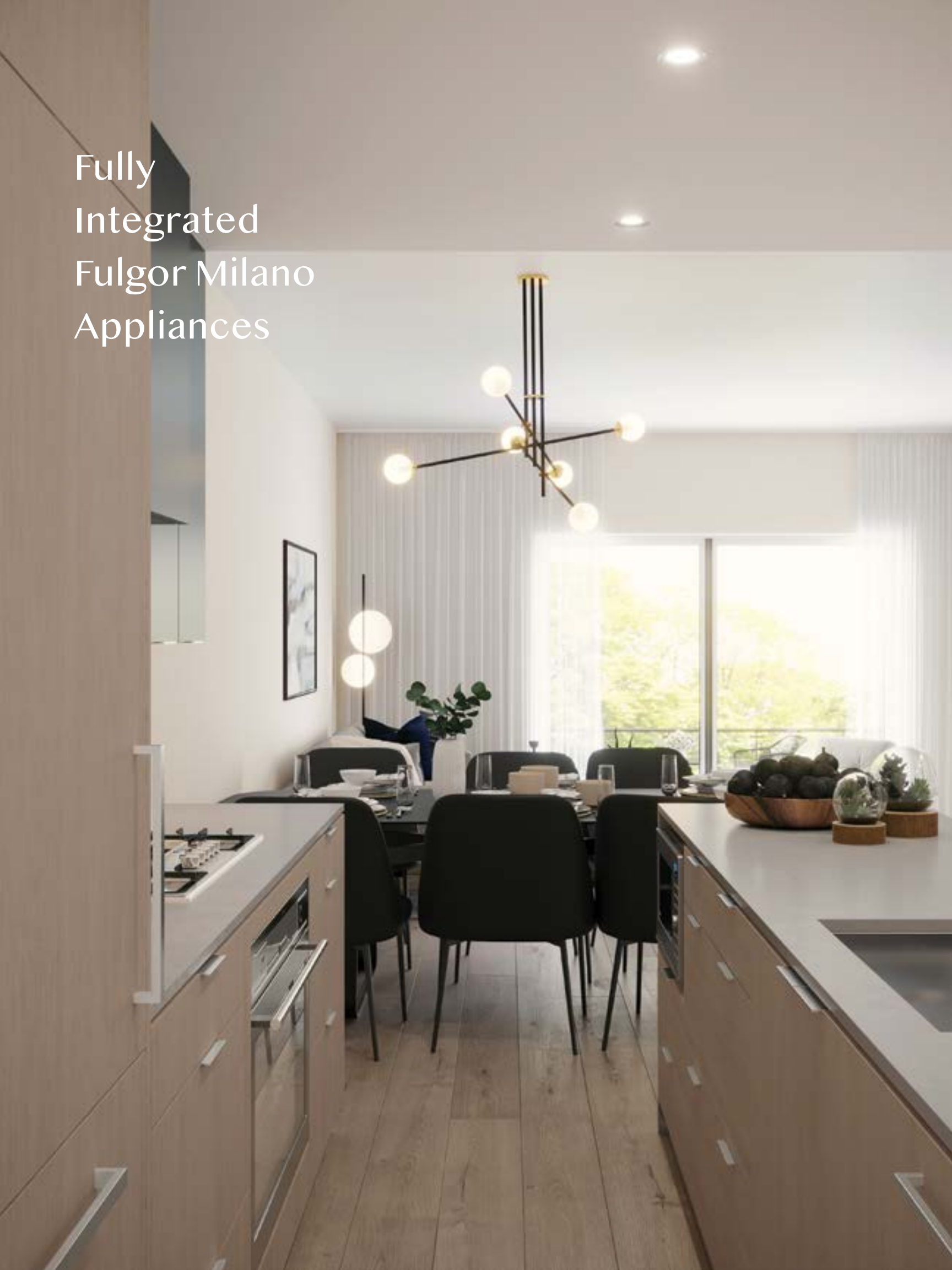

A Dream Kitchen Fit For A Chef

Step into the exquisitely designed kitchen and appreciate the meticulous attention to detail that gives rise to a grand, yet functional space. The three ultra-modern color palettes offer homebuyers an opportunity to curate a kitchen that is as visually striking as it is practical. The sleek granite waterfall counters and Italian-made stainless steel appliances by Fulgor Milano are not only aesthetically pleasing but also speak to the sophistication of the home.

Every inch of the kitchen has been thoughtfully designed to maximize space utilization, resulting in unusually generous storage space. These exquisite design elements exude an unparalleled allure, providing the perfect ambiance for any occasion - from a formal soirée to a casual family gathering. Immerse yourself in the ultimate culinary experience in our artfully crafted kitchen, where luxury, style and function intersect seamlessly.



Unequivocally Yours

Burqville is committed to enabling our residents to live life to its fullest potential. We offer a range of flexible living concepts that cater to every lifestyle. Our homes are designed to provide a dynamic living space, including the large and expansive rooftop oasis, where homeowners can extend their living. This outdoor retreat is the perfect setting to relax, entertain, or simply enjoy the open skys and take in the sun.

PLAN A TYPE FEATURES

- Three full size bedrooms
- Three full bathrooms
- 9 Feet ceiling height throughout
- Balcony off the living room
- Over 400 sqft rooftop terrace





Rooftop Paradise

A Private Oasis Awaits

With a unique and distinctive feature that sets it apart, Burqville offers a private rooftop for all upper level homes, thanks to its west coast architecture. Make the most of your rooftop by transforming it into an extension of your living space. Imagine enjoying a tranquil morning yoga session or cultivating a garden in the sky right above your home. How about setting up camp for the kids or hosting guests with a stunning evening party under the stars?

Framed glass railings provide security and style to the sleek rooftop, which offers a perfect spot to unwind in quiet seclusion. BBQs are made possible with ample space for food preparation, and enough space to fit outdoor dining for a party of six, the possibilities for your private rooftop are endless, limited only by your imagination.



Rooftop Oasis

Find your own private haven in the heart of the city with our rooftop living space.





Extra Large Master Bedrooms

With Ensuite

Burqville residences feature expansive master bedrooms and generously-sized second and third bedrooms, providing enough room for a variety of furniture pieces, such as credenzas and side tables. The versatile and highly functional layouts can be easily adapted to accommodate

individual preferences and needs. In-unit Storage options contribute to maintaining a well-organized and clutter-free living space while elegant ensuite bathrooms offer privacy and comfort, distinguished by high-quality materials, premium fixtures, and thoughtful design elements.



Ensuite

Unwind and Rejuvenate

A true 5-piece ensuite at Burqville offers the ultimate comfort with abundant space and distinct zones for the bathtub and shower, equipped with dual rain and handheld showerheads to perfect the spa-like setting. The sophisticated quartz countertop and vanity, featuring two undermount sinks, allow for time-saving preparations on busy days while fostering an atmosphere relaxation and rejuvenation in this thoughtfully designed space.

Agile Living

Full Size Multi-purpose Room

Burqville takes pride in its innovative layout design for three-bedroom townhomes, featuring a full-sized bedroom on the main level. This versatile room offers homeowners increased flexibility in the utilization of their space. Envision an office on the main level, enhanced privacy and separation between guests and residents, or a children's room situated near the lively living and dining areas. The endless adaptability presents a true advantage, adding value for both the present and future.

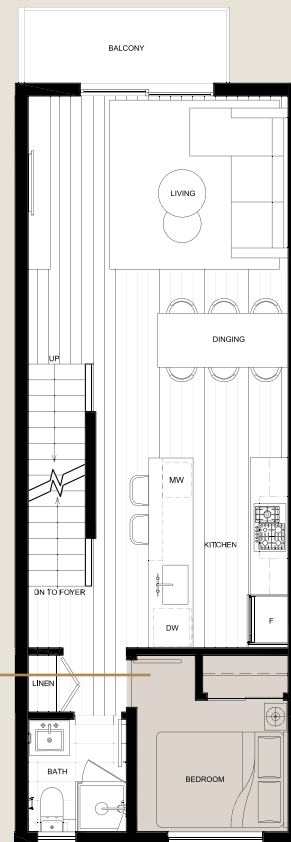

Unique Full Size Room
on Main Level





Home Office



Artist Studio



Play Room



Guest Bedroom



Personal Gym



Entertainment Room



The Courtyard

Serene and tranquil water feature welcomes residents and guests

Enter the secure gates of Burqville, and allow the tranquil sounds of water lead you to your haven. The meticulously landscaped courtyard, adorned with a carefully selected mix of flora and fauna extends a warm welcome to all. The peaceful ambiance, complemented by abundant seating, soothes the soul, while the lively children's play area fosters a sense of community. Welcome home.





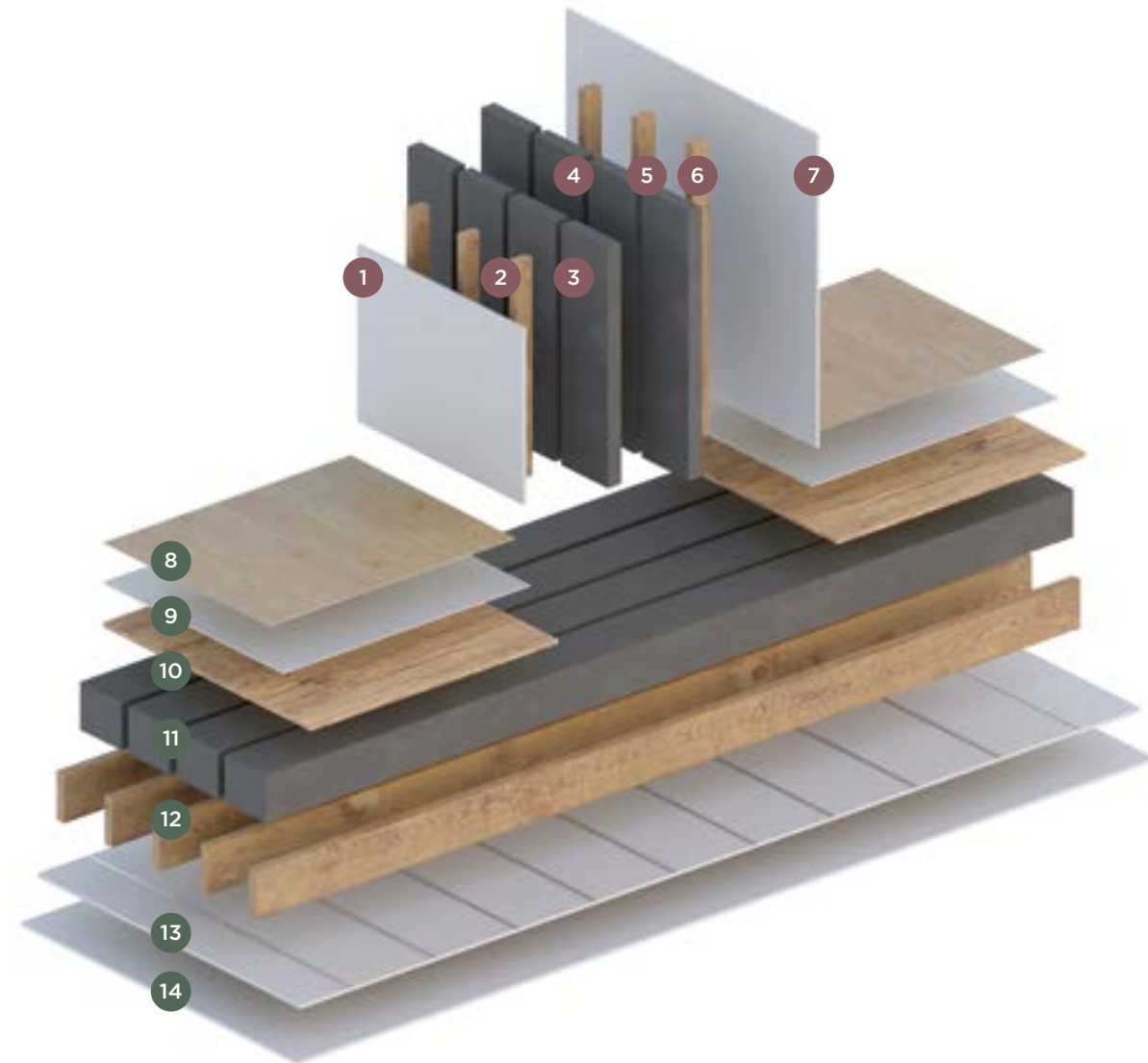

Optimized for Comfort

Thoughtfully Designed Layouts & Advanced Building Technology.

NOISE-CANCELLING DIVISION WALL

- 1 5/8" type 'X' gypsum board
- 2 High density insulation
- 3 2x4 wood studs
- 4 1" airspace
- 5 High density insulation
- 6 2x4 wood studs
- 7 5/8" type 'X' gypsum board

SOUND ABSORBING FLOOR

- 8 Floor finish - SPC waterproof flooring
- 9 Light weight concrete
- 10 3/4" tongue and groove plywood sheathing
- 11 High density insulation
- 12 10" joists
- 13 Resilient channels
- 14 2 layers - 5/8" type 'X' gypsum board

Upper strata unit

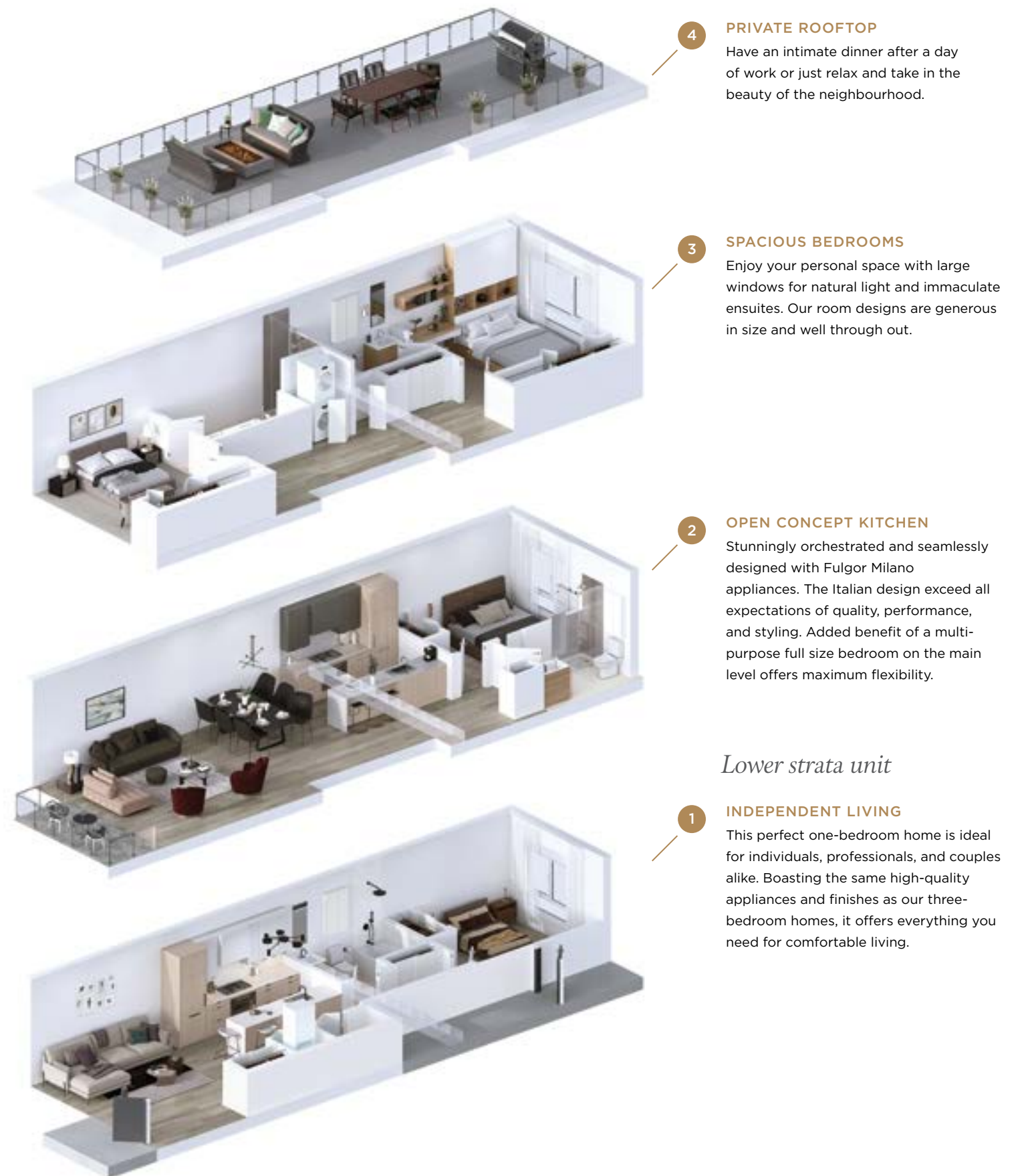

4 PRIVATE ROOFTOP
Have an intimate dinner after a day of work or just relax and take in the beauty of the neighbourhood.

3 SPACIOUS BEDROOMS
Enjoy your personal space with large windows for natural light and immaculate ensuites. Our room designs are generous in size and well through out.

2 OPEN CONCEPT KITCHEN
Stunningly orchestrated and seamlessly designed with Fulgor Milano appliances. The Italian design exceed all expectations of quality, performance, and styling. Added benefit of a multi-purpose full size bedroom on the main level offers maximum flexibility.

Lower strata unit

1 INDEPENDENT LIVING
This perfect one-bedroom home is ideal for individuals, professionals, and couples alike. Boasting the same high-quality appliances and finishes as our three-bedroom homes, it offers everything you need for comfortable living.

Development Team



In the face of dynamic economic conditions and ever-evolving regulations in the real estate market, we remain committed to coming together, planning ahead and adapting to change. Our business strategy centers on innovation and transformation,

ensuring we not only comply with policy requirements but also stay ahead of emerging market trends. As enthusiastic developers, our goal is to create and deliver exceptional living environments that prioritize comfort and stand the test of time.

"For us, a home is so much more than a blueprint. It's a place where the stories begin and where memories are created. It's with this philosophy that our team has carefully crafted and built homes for over 35 years!"

JIM HSU - Senior Project Director

PAST PROJECT EXPERIENCE

NEW OAK



SONATA PARK



LA VERNA



Avanture Architects

Architect

Avanture Architects (AA), headquartered in Vancouver, is a leading architecture firm with two subsidiary offices in Shanghai and Taipei. The founding partners and senior staff possess over 15 years of extensive experience in both local and international practice, ensuring a wealth of expertise that is second to none. With a staff of over 20 professionals, the Vancouver office comprises a diverse and talented team with backgrounds spanning the spectrum of the industry.



Interior designer

Guiding clients from concept to completion, the AK design team employs a dedicated process that prioritizes logistics and a clear understanding of construction. Drawing upon extensive experience and top-notch professional insight, the team maintains seamless collaboration with architects, vendors, and trades to deliver beautiful spaces with optimal efficiency and success. With a focus on exceptional service and a commitment to fostering trust among all project partners, the AK approaches each project with a passion for collaboration and a keen eye for detail.

EVERMARK™

Real Estate Services

Evermark is a brand designed with a singular purpose - to create long-lasting, positive impacts on neighbourhoods through sustained and thoughtful development initiatives while providing end-to-end real estate sales and services through its EM 360[®] solution. This goal aligns with the larger community-driven efforts of all conscientious developers who aim to improve the quality of life for homeowners. Founded by Simon Chang and Fred Zhang, the brand signifies the indelible impression that development initiatives aim to make on the communities they serve.

EPICINSPIRED.

Marketing

Founded in 2001, Epic Inspired is a full-service creative agency renowned for delivering exceptional branding and marketing solutions to high-end global brands, with a specific focus on Real Estate and Hospitality. Led by a team of experienced professionals, Epic takes a tailored, results-driven approach to project development, from inception to execution. With an impressive portfolio of 87 developments and over 200 branding projects, Epic has distinguished itself by designing its reputation as an industry-leading marketing agency.



This is not an offering for sale. Any such offering can only be made after a disclosure statement. The Developer reserves the right to make modifications or changes to the information contained herein. Renderings are representational only and subject to change. Dimensions, sizes, specifications, layouts and materials are approximate only and subject to change without notice. E. & O.E.

Copyright © 2023 Kadium Properties Ltd. All rights reserved. | Designed by Epic Inspired





DEVELOPMENT BY

KADIUM
PROPERTIES

SALES BY

EVERMARK™

burqville.com